

# 115th INAWWA Annual Conference

## AT A GLANCE PROGRAM

### \*\* MONDAY, April 10 \*\*

**3:00p - 7:00**

Exhibitor sign in & set up - Registration 2

Non Registered Attendees - Registration 1

### \*\* TUESDAY, April 11 \*\*

**Exhibits Open: 8:00a - 5:30p**

**Registration Open: 7:15a**

8:00a - 9:30 Opening Session  
Welcome  
Visiting AWWA Dignitary  
Keynote

9:30 - 10:15 Break - Exhibit Hall Open!

10:15 - 11:45 Sessions

12:00p - 1:30 Lunch  
Sponsored by 

1:30 - 3:00 Sessions

3:00 - 3:45 Break - Exhibit Hall Open!

3:45 - 5:15 Sessions

5:30 - 6:30 Fuller Reception  
Sponsored by



8:00 - 11:00 Utility Supply Co. Party  
Slippery Noodle



### **SAFETY WHEEL OF FORTUNE**

Denver Room

Tuesday - 8:00a - 5:00p & Wednesday - 8:00a - Noon

Contact Committee Chair  
for Committee Meeting schedule

### \*\* WEDNESDAY, April 12 \*\*

**Exhibits Open: 8:00a - 3:45p**

**Registration Open: 7:15a**

8:00a - 9:30 Sessions

9:30 - 10:15 Break - Exhibit Hall Open!

10:15 - 11:45 Sessions

12:00p - 1:30 Lunch  
Sponsored by



1:30 - 3:00 Sessions

3:00 - 3:45 Break - Exhibit Hall Open!

3:45 Exhibit Hall Tear Down

3:45 - 5:15 Sessions

5:30 - 6:30 Meet & Greet Reception  
Sponsored by



Featuring -  
Hydrant Hysteria  
Demonstration

6:00 - 8:00 Social Cantina  
Young Professionals  
Reception

7:00 - 10:00 Punch Bowl Social  
Sponsored by



### \*\* THURSDAY, April 13 \*\*

**Registration Open: 7:15a**

8:00 - 8:30 Breakfast  
Sponsored by



8:30 - 10:00 Legislative & Regulatory  
Update



## FIRST FLOOR

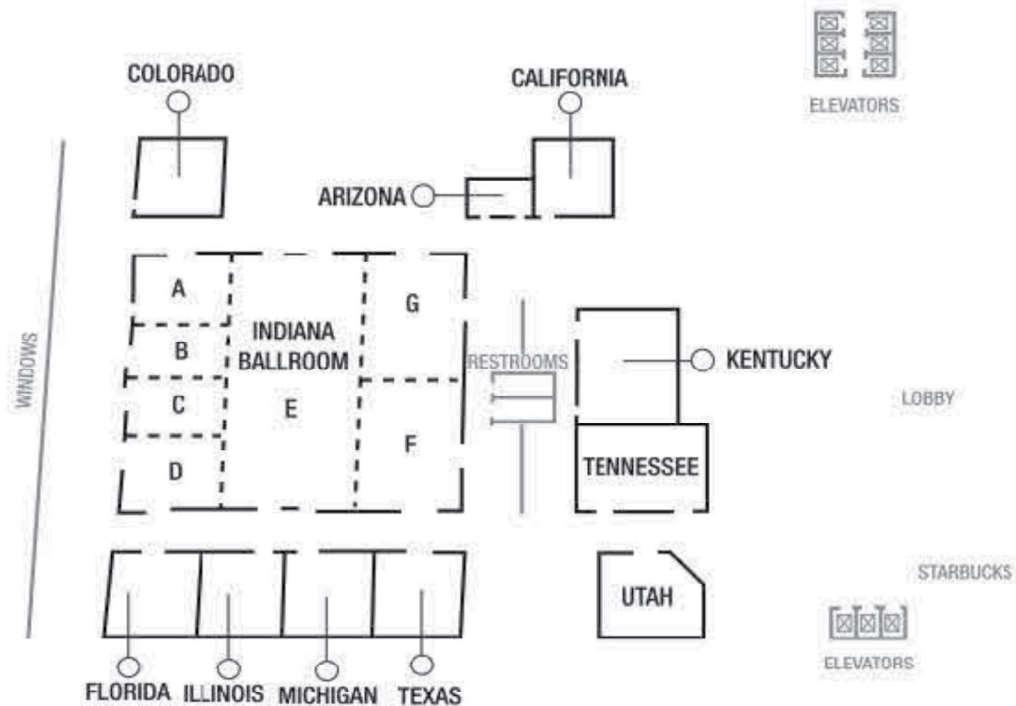

## SECOND FLOOR

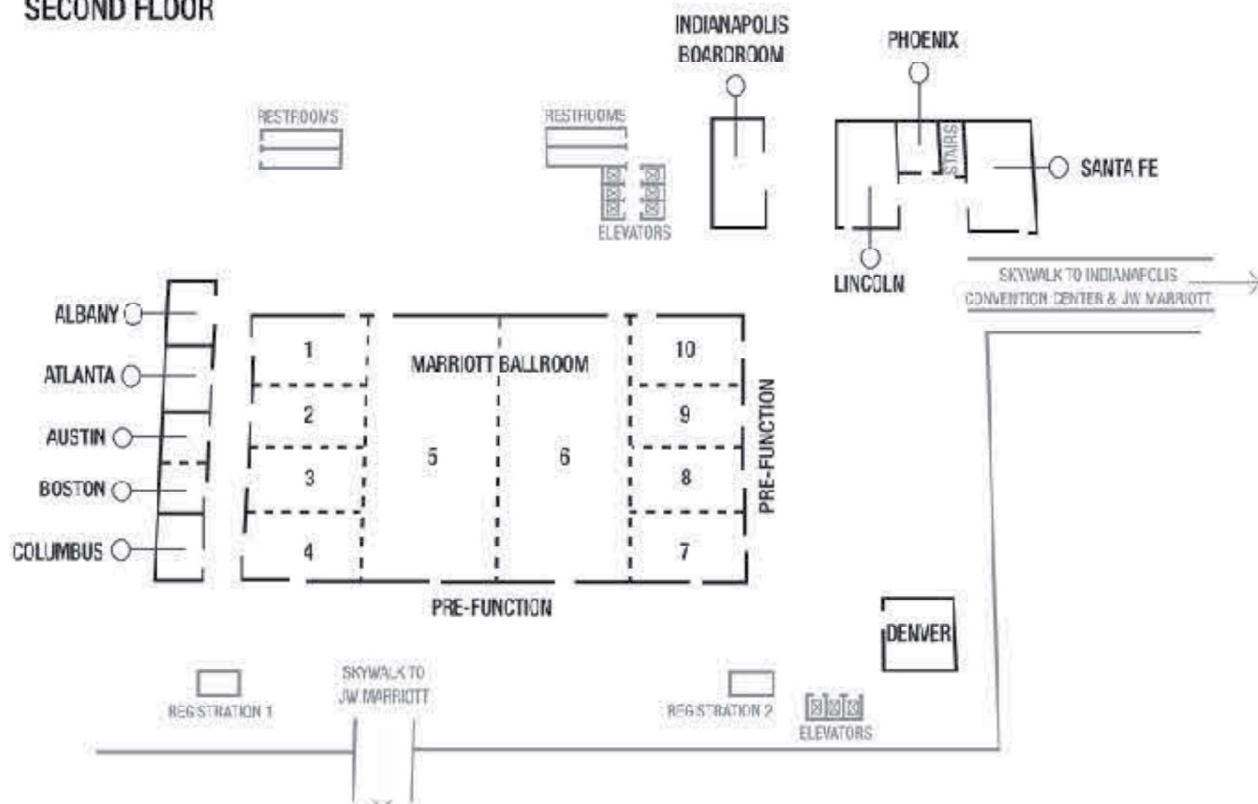

	Indiana Section AWWA 115th Annual Conference 2023 Technical Program			
	Tuesday, April 11, 2023			
	Education/Contact Hour Key: <b>WT</b> - Water Technical CEU; <b>WWG</b> - Wastewater General CEU; <b>WWT</b> - Wastewater Technical CEU; <b>PDH</b> - Engineer Professional Development Hour; <b>WPDI</b> - Well Driller/Pump Installer Contact Hour; <b>V</b> -Validator			
Room	Indiana Ballroom A-D	Marriott Ballroom 1-2	Marriott Ballroom 3-4	Lincoln
		INAWWA Annual Conference Opening Session Moderator: Chris Harrison , INAWWA Director		
8:00 am to 8:15 am		Welcome to INAWWA Annual Conference 2023 John Crider, INAWWA Chair, Board of Trustees Opening Ceremony, Presentation of the Flag		
8:15 am to 8:45 am		Visiting AWWA Dignitary, Welcome and Association Updates Juanita Colon, AWWA Vice President		
8:45 am to 9:35 am		Keynote: Amanda Canida, Black & Veatch Surveying Costs on the PFAS Roadmap (WT / PDH: 1.0; WWT: 1.0) Opening Session Sponsored by Ferguson Waterworks		
9:35 am to 10:15 am	Break - Visit the Exhibit Hall			
Track 1	Operations and Maintenance	AMR / AMI	Asset Management	Wastewater Technical
Moderator	Volunteer Moderator	Volunteer Moderator	Volunteer Moderator	Volunteer Moderator
10:15 am to 10:45 am	Evansville's Proactive Approach to Maintaining Critical Water Mains  Duane Gilles, Crawford, Murphy & Tilly Wayne Lindsay, Xylem (WT / PDH: 1.0; WWG: 1.0; WDPI: 1.0)	How to Select and Upgrade AMI / AMR Systems in 2023 Ben Christiansen, Utility Supply Co. (WT / PDH: 1.0; WWG: 1.0; WDPI: 1.0)	Building an Asset Management Plan that Fits Your Utility Adam Hershberger & Josh Hawley, Zipitlity (WT / PDH: 0.5; WWT: 0.5; V:0.5)	Real Time Nitrate Monitoring for Aeration Basin Control Mark Bowkett, Aquamonitrix  (WT / PDH: 1.0; WWT: 1.0; WDPI: 1.0)
10:45 am to 11:15 am			Condition Assessment of Parallel Raw Water Mains Ben Gensic, Fort Wayne City Utilities Dustin Park, Pure Technologies (WT / PDH: 0.5; WWG: 0.5; WDPI: 0.5; V:0.5)	
11:15 am to 11:45 am	Evolving Technology - Introduction to Manufactured In-place Composite Pipe (MICP) Laura Schmidt & Luke Kunkel, SippTech  (WT / PDH: 0.5; WWT: 0.5; WDPI: 0.5)	Evolving Cellular Technology and the Implications for AMI Applications Andrea Amato, Neptune  (WT / PDH: 0.5; WWG: 0.5; WDPI: 0.5)	Asset Management and Condition Assessment for Iron Pipe Paul Hanson, DIPRA  (WT / PDH: 0.5; WWT: 0.5; WDPI: 0.5; V:0.5)	On-site Chlorine Generation - A Technical Solution for Chemical Supply Chain Woes Joe Ciurlino, Evoqua Water Technologies  (WT / PDH:0.5; WWT:0.5; WDPI: 0.5)
12:00 pm to 1:30 pm	Membership Lunch / Awards Presentation, sponsored by: Beam, Longest & Neff - located in the Indiana Ballrooms			
Track 2	Emerging Contaminants	Water Treatment / Water Quality	Case Studies	Water Loss Audits
Moderator	Volunteer Moderator	Volunteer Moderator	Volunteer Moderator	Volunteer Moderator
1:30 pm to 2:00 pm	A 6-year US National Study: Finding, Predicting & Resolving Building Water System Chemical & Microbiological Contamination  Andrew Whelton, Purdue University (WT / PDH: 1.0; WWG: 1.0; WDPI: 1.0)	Ammonia Removal by Biological Filtration in Drinking Water Treatment Anne Hayes & Adam Sitka, Wessler Engineering (WT / PDH: 0.5; WWG: 0.5; WDPI: 0.5)	Citizens Energy Group Lead Service Line Replacement Program and Implementation Jamie Schultz, Citizens Energy Group (WT / PDH: 0.5; WWG: 0.5; WDPI: 0.5)	Water Loss Audits: Town of Osgood Case Study Toney Wood, Treanne Quick & Rachel Runge, Commonwealth Engineers (WT / PDH: 0.5; WWG: 0.5; WDPI: 0.5; V:0.5)
2:00 pm to 2:30 pm		Total Alkalinity Kevin Formsman, Swan Analytical (WT / PDH: 0.5; WWG: 0.5; WDPI: 0.5)	DeMotte / NORWEJ Water Extension to I-65 Daryl Knip, Abonmarche; Dennis Otten, Bose McKinney & Evans; and Mitchell Eschweiler, Baker Tilly (WT / PDH: 0.5; WWG: 0.5)	Water Loss Audits: Lessons Learned Natalie Schelling, Rachel Runge Commonwealth Engineers (WT / PDH: 0.5; WWG: 0.5; WDPI: 0.5; V:0.5)
2:30 pm to 3:00 pm	Comparing Legionella Detection Methods & the Importance of Testing via Indiana Department of Health Sarah Zekovich, Indiana Dept of Health (WT / PDH: 0.5; WWG: 0.5; WDPI: 0.5)	Iron Removal in Drinking Water with High Organics - Lewisville, IN Case Study Paula Araya, AdEdge Water Technologies (WT / PDH: 0.5; WWG: 0.5; WDPI: 0.5)	South Bend Pinhook WTP Improvements: A GSC Success Story Catherine Pallotta, American Structurepoint Steve Nutt, Bowen Engineering (WT / PDH: 0.5; WWG: 0.5)	The Indiana Finance Authority's Water Loss Final Report 2022 Sarah Hudson & Evan Fall Indiana Finance Authority (WT / PDH: 0.5; WWG: 0.5; WDPI: 0.5; V:0.5)
3:00 pm to 3:45 pm	Break - Visit the Exhibit Hall			
	Exhibit Hall - All Day			
Track 3		The State of the Industry (the Business)	Lead Part 1	Source Water
Moderator		Volunteer Moderator	Volunteer Moderator	Volunteer Moderator
3:45 pm to 4:15 pm		The State of the Industry And By That, We Do Mean the Business  Panel Discussion: Utility Professionals  (W T / PDH: 1.5; WWG: 1.5)	History of Water Service Lines Andrew Gordon & Madeline Pritchett Wessler Engineering (WT/ PDH: 0.5; WWG: 0.5)	Source Water Protection: Agricultural Practices and Programs that Promote Ginger Davis Indiana Geologic & Water Survey (WT/ PDH: 0.5; WWG: 0.5; WDPI: 0.5)
4:15 pm to 4:45 pm			Swordfish - The First Machine Intelligent Tool for the Identification of Lead Service Lines - A Case Study Mike App, Electroscan (WT/ PDH: 0.5; WWG: 0.5; WDPI: 0.5)	Source Water Protection Programs: A Roadmap to Adoption Ginger Davis Indiana Geologic & Water Survey (WT/ PDH: 0.5; WWG: 0.5; WDPI: 0.5)
4:45 pm to 5:15 pm			An Online Platform for LCRR School and Child Care Testing Stacy Jones, IDEM Sarah Hudson & Evan Fall, IFA (WT/ PDH: 0.5; WWG: 0.5; WDPI: 0.5)	GIS: Tool for Source Water Protection Rachel Walker Indiana Geologic & Water Survey (WT/ PDH: 0.5; WWG: 0.5; WDPI: 0.5)
5:30 pm to 6:30 pm	Fuller Reception, sponsored by: Bastin Logan Water Services & Wessler Engineering - located in the Indiana Ballrooms			
	*This schedule is subject to change	*All Water, Wasterwater, WD / PI, Validator CEUs Approved		

Indiana Section AWWA 115th Annual Conference 2023				
Technical Program				
Wednesday, April 12, 2023				
Education/Contact Hour Key: <b>WT</b> - Water Technical CEU; <b>WWG</b> - Wastewater General CEU; <b>WWT</b> - Wastewater Technical CEU; <b>PDH</b> - Engineer Professional Development Hour; <b>WDPI</b> - Well Driller/Pump Installer Contact Hour; <b>V</b> -Validator				
Room	Indiana Ballroom A-D	Marriott Ballroom 1-2	Marriott Ballroom 3-4	Lincoln
Track 1	Disinfection		Wastewater Technical	Workforce Initiatives
Moderator	Volunteer Moderator	Volunteer Moderator	Volunteer Moderator	Volunteer Moderator
8:00 am to 8:30 am		On-site Sodium Hypochlorite Generation: A Safe & Reliable Disinfection Alternative to Bulk Sodium Hypochlorite & Gas Chlorine Tom Caulfield, PSI Water Technologies <b>(WT / PDH: 0.5; WWT: 0.5; WDPI: 0.5)</b>	Liquids Solids Separation Jar Testing John Dailey, Brenntag <b>(WT / PDH: 0.5; WWT: 0.5; WDPI: 0.5)</b>	Recruiting and Retaining Veterans in the Water and Wastewater Utility Industry  Sarah Hudson, Indiana Finance Authority Scott Ham, Silver Creek Water  <b>(WT / PDH: 1.5; WWG: 1.5; WDPI: 1.5)</b>
8:30 am to 9:00 am		Converting Indiana American Water's Largest Water Treatment Plant from Chlorine to Sodium Hypochlorite  Kimberly Stefanich, Matt Charles, David Lalibere Indiana American Water, Hazen & Sawyer <b>(WT / PDH: 1.0; WWT: 1.0; WDPI: 1.0)</b>	Phosphorous Removal Michael Sapienza, Hawkins <b>(WT / PDH: 0.5; WWT: 0.5; WDPI: 0.5)</b>	
9:00 am to 9:30 am			Wastewater Process Controls Visualization Jill Minor, City of Bloomington Utilities <b>(WT / PDH: 0.5; WWT: 0.5; WDPI: 0.5)</b>	
9:30 am to 10:15 am	Break - Visit the Exhibit Hall			
Track 2	Rates & Finance	Distribution Water Quality	Water Loss Technology	Water Loss
Moderator	Volunteer Moderator	Volunteer Moderator	Volunteer Moderator	Volunteer Moderator
10:15 am to 10:45 am	Bond Market Update  Ross Hagan & Scott Hadler Baker Tilly Municipal Advisors <b>(WT / PDH: 0.5; WWG: 0.5; WDPI: 0.5)</b>	Chloramine Disinfectant Residual Optimization in Distribution Systems  Tom Caulfield PSI Water Technologies <b>(WT / PDH: 1.0; WWG: 1.0; WDPI: 1.0)</b>	Traditional and Remote Leak Detection  Aaron Horbovetz M.E. Simpson Company <b>(WT / PDH: 1.0; WWG: 1.0; WDPI: 1.0; V: 1.0)</b>	Water Loss Audit Refresher  Jeff Cuninghame, ME Simpson Co  <b>(WT / PDH: 1.5; WWG: 1.5; WDPI: 1.5; V:1.5)</b>
10:45 am to 11:15 am	Inflation Reduction Act Funding Opportunities  Jeff Rowe, Baker Tilly Municipal Advisors <b>(WT / PDH: 0.5; WWG: 0.5; WDPI: 0.5)</b>			
11:15 am to 11:45 am	Building Your Financial Resilience Tyler Coffel & Bill Gabbard Baker Tilly Municipal Advisors <b>(WT / PDH: 0.5; WWG: 0.5; WDPI: 0.5)</b>	Real Time Nitrite Monitoring for Nitrification Control in Chloraminated Water Systems Mark Bowkett, Aquamonitrix <b>(WT / PDH: 0.5; WWG: 0.5; WDPI: 0.5)</b>	Leveraging Technology in Rural Indiana  Audi Findley Greenville, Indiana <b>(WT / PDH: 0.5; WWG: 0.5; WDPI: 0.5; V:0.5)</b>	
12:00 pm to 1:30 pm	Lunch <i>sponsored by:</i> S & K Equipment - located in the Exhibit Hall			
Track 3	Digital Solutions	Operation & Maintenance	Case Study	Cybersecurity
Moderators	Volunteer Moderator	Volunteer Moderator	Volunteer Moderator	Volunteer Moderator
1:30 pm to 2:00 pm	More Than Just Alarming: Modern Monitoring Solutions Help Utilities Optimize Assets with Data  Kevin Stock, Streametric <b>(WT / PDH: 0.5; WWT: 0.5; WDPI: 0.5)</b>	Line Stops and Insertion Valves Tom Franklin, Culy Contracting  <b>(WT / PDH: 1.0; WWG: 1.0; WDPI: 1.0)</b>	Lead and Copper Rule Revisions: Citizens' Roadmap to Compliance  Dan Moran & Ann McIver, Citizens Energy Group <b>(WT / PDH: 0.5; WWG: 0.5; WDPI: 0.5)</b>	Cybersecurity Workshop  Dawn Keyler & Brian Price, Wessler Engineering Jaimie Foreman, City of Carmel Utilities  <b>(WT / PDH: 4.0; WWT: 4.0; WDPI: 4.0)</b>
2:00 pm to 2:30 pm	Developing a GIS Based Work Order System  Jeff Weaver, Abonmarche <b>(WT / PDH: 0.5; WWT: 0.5; WDPI: 0.5)</b>		All That Data! Open Source Tools that Bring the Data to Decision-Makers  Jill Minor, City of Bloomington <b>(WT / PDH: 1.0; WWG: 1.0; WDPI: 1.0)</b>	
2:30 pm to 3:00 pm	Greenville IN Runs Digital Water System Scenarios to Serve Customers Better Audi Findley, Greenville IN Luke Butler, Qatium <b>(WT / PDH: 0.5; WWT: 0.5; WDPI: 0.5)</b>	Tank Evaluations: Making the Right Choice for You Ryleigh White, Tank Industry Consultants <b>(WT / PDH: 0.5; WWG: 0.5; WDPI: 0.5)</b>		
3:00 pm to 3:45 pm	Break - Visit the Exhibit Hall			This workshop is grant funded by the Indiana Finance Authority and held in conjunction with Annual Conference. It requires a separate registration. Please visit our event listing on our website. Or stop by Registration 2 desk
Track 4	Young Professionals	Emerging Contaminants	Lead Part 2	
Moderators	Volunteer Moderator	Volunteer Moderator	Volunteer Moderator	
3:45 pm to 4:15 pm	Presentations That Get Standing Ovations  Teddy Deahl, Bowen Engineering Bridget Ingram, Wessler Engineering <b>(WT / PDH: 0.5; WWG: 0.5)</b>	PFAS SDWA Regulatory status and UCMR 5 Updates for Water Systems Kevin Custer, Pace <b>(WT / PDH: 0.5; WWG: 0.5; WDPI: 0.5)</b>	Lead Service Line Replacement: Best Practices Bill Etzler & Jeff Weaver Abonmarche  <b>(WT / PDH: 1.0; WWG: 1.0; WDPI: 1.0)</b>	
4:15 pm to 4:45 pm	Tactical Life Planning  Bruce Cooley, Citizens Energy Group  <b>(WT / PDH: 1.0; WWG: 1.0)</b>	Understanding Microplastics Found at Building Faucets: Types, Sources, Implications and Knowledge-Gaps Paula Coelho, Purdue University <b>(WT / PDH: 0.5; WWG: 0.5; WDPI: 0.5)</b>		
4:45 pm to 5:15 pm		UV Disinfection for Emerging Contaminants and Chlorine Resistant Pathogens Joe Ciurlino, Evoqua Water Technologies <b>(WT / PDH: 0.5; WWT: 0.5; WDPI: 0.5)</b>	Developing Bloomington's Lead Service Line Inventory Vic Kelson, City of Bloomington <b>(WT / PDH: 0.5; WWG: 0.5; WDPI: 0.5)</b>	
5:30 pm to 6:30 pm	Meet and Greet Reception with Hydrant Hysteria Demonstration <i>sponsored by:</i> National Water Services - located in the Indiana Ballrooms			
	*This schedule is subject to change.	**All Water, Wastewater, WDPI, Validator CEU's Approved		

	<b>Indiana Section AWWA 115th Annual Conference 2023</b>		
	<b>Technical Program</b>		
	<b>Thursday, April 13, 2023</b>		
	<u>Education/Contact Hour Key:</u> <b>WT</b> - Water Technical CEU; <b>WWG</b> - Wastewater General CEU; <b>WWT</b> - Wastewater Technical CEU; <b>PDH</b> - Engineer Professional Development Hour; <b>WPDI</b> - Well Driller/Pump Installer Contact Hour		
<b>Room</b>		<b>Marriott Ballroom 7-10</b>	
<b>8:00 am to 8:30 am</b>		<b>Breakfast <i>sponsored by:</i> Commonwealth Engineers - located outside Marriott Ballroom 7-10</b>	
<b>Track</b>		<b>Legislation and Water</b>	
<b>Moderator</b>		<i>Scott Miller</i>	
<b>8:30 am to 10:00 am</b>		<p><b>Legislative and Regulatory Update</b></p> <p><b>Legislative Update:</b> Chris Janak, Bose, McKinney &amp; Evans</p> <p><b>Innovative Funding for Customer Side Lead Service Line Replacement</b>  Nathan Anderson, Assistant Vice President, Federal Reserve Bank of Chicago  Bill Harkins, Program Director, Indiana Finance Authority  Dennis Otten, Bose McKinney &amp; Evans  Scott Miller, Baker Tilly Municipal Advisors</p> <p>(<b>WT</b> / <b>PDH</b>: 1.5; <b>WWG</b>: 1.5)</p>	
*This schedule is subject to change    **All Water, Wastewater, WD /PI, Validator Approved			



PO Box 127  
Brownsburg, IN 46112

866-213-2796

#### TO REGISTER



QR CODE TO DOWNLOAD  
OUR ANNUAL CONFERENCE APP



**Indiana Section AWWA thanks our ...**  
**2023 ANNUAL PARTNER SPONSORS**

#### SOURCE WATER PARTNER



#### TRANSMISSION PARTNER



#### STORAGE PARTNER



#### METER PARTNER



## Indiana Section AWWA 115th Annual Conference 2023 Exhibit Hall Presentations

**Education/Contact Hour Key:** **WT**- Water Technical CEU; **WWG**- Wastewater General CEU;  
**WWT**- Wastewater Technical CEU; **PDH**- Engineer Professional Development Hour;  
**WPDI**- Well Driller/Pump Installer Contact Hour; **V**-Validator

**Tuesday, April 11, 2023**

**Wednesday, April 12, 2023**

9:00 am to 9:30am	<b>The Latest Advancement in Corrosion Control</b> Mark Troyanowski & Jonathon Keener, SIP <b>BOOTH #402</b>  (WT / PDH: 0.5; WWG: 0.5; WPDI: 0.5)	<b>Digital Asset Management</b> Jim Kelleher, APX10 <b>BOOTH #909</b>  (WT / PDH: 0.5; WWG: 0.5; WPDI: 0.5)
10:30 am to 11:00 am		<b>New Technologies for Joining and Restraining Pipe</b> Kenneth Alessi, Hymax <b>BOOTH #502</b>  (WT / PDH: 0.5; WWT: 0.5; WPDI: 0.5)
11:00 am to 11:30 am	<b>What the Water Professional is Asking About Brass</b> Frank Palmisano, A.Y. McDonald <b>BOOTH #518</b>  (WT / PDH: 0.5; WWG: 0.5; WPDI: 0.5)	<b>New Method to Detect Nanoplastics in Wastewater &amp; Water Sheds</b> Poster Presentation, Vidhatri Iyer <b>LOCATED IN CENTER OF EXHIBIT HALL</b>  (No ceu's available)
12:00 pm to 1:30 pm	<b>Membership Lunch / Awards Presentation,</b> <i>sponsored by</i> Beam, Longest & Neff - located in the Indiana Ballrooms	<b>Wednesday Lunch,</b> <i>sponsored by</i> S & K Equipment - located in the Exhibit Hall
1:30 pm to 2:00 pm	<b>Fixed and Mobile Leak Detection</b> Justin Lisch, E.J. Prescott <b>BOOTH #302</b>  (WT / PDH: 0.5; WWG: 0.5; WPDI: 0.5)	